



SELL • LET • MANAGE

18 Connaught Avenue
Plymouth, PL4 7BX

£95,000 Leasehold



18 Connaught Avenue

, Plymouth, PL4 7BX

DC Lane are thrilled to present a one bedroom apartment located along a tree lined avenue just off Mutley Plain with close proximity to the shopping parade and within walking distance to the City Centre.

Positioned on the ground floor this apartment comprises of open plan lounge/diner with a beautiful period fireplace and feature cupboards in the alcoves. There is a kitchen, double bedroom and shower room and the property has the added benefits of gas central heating and double glazing.

Previously let for many years this property is being sold with no chain and would make an ideal First Time Buy or Buy to Let investment.

MOVE FASTER WITH PRIORITY PACK - AVAILABLE ON THIS PROPERTY Call for more information. or click www.dclane.co.uk/priority-pack

- Ground Floor Flat
- One Bedroom
- Mutley Location
- Original Features
- Shower Room
- Gas Central Heating
- 999 Year Lease
- Ideal FTB/ Buy to Let
- No Onward Chain
- Council Tax Band A

Council tax band: A



Ground Floor

Lounge 13'6" x 16'11" (4.13 x 5.17)

Kitchen 7'6" x 9'2" (2.30 x 2.80)

Bedroom 8'0" x 9'1" (2.44 x 2.78)

Shower Room 8'0" x 4'3" (2.44 x 1.30)



Floor Plan

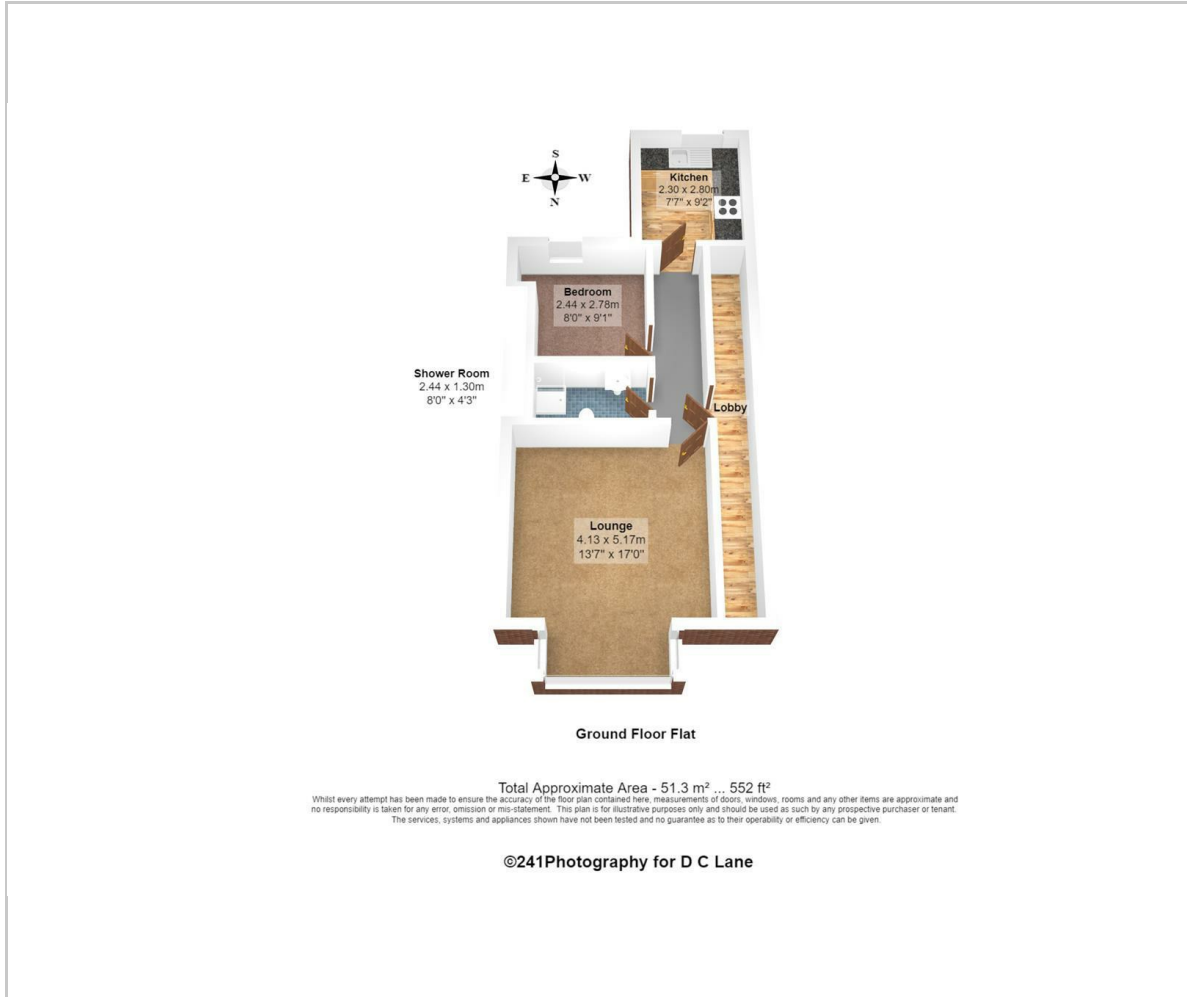

Viewing

Please contact our DC Lane, Plymouth Office on 01752 874242 if you wish to arrange a viewing appointment for this property or require further information.

These particulars, whilst believed to be accurate are set out as a general outline only for guidance and do not constitute any part of an offer or contract. Intending purchasers should not rely on them as statements of representation of fact, but must satisfy themselves by inspection or otherwise as to their accuracy. No person in this firms employment has the authority to make or give any representation or warranty in respect of the property.

Area Map

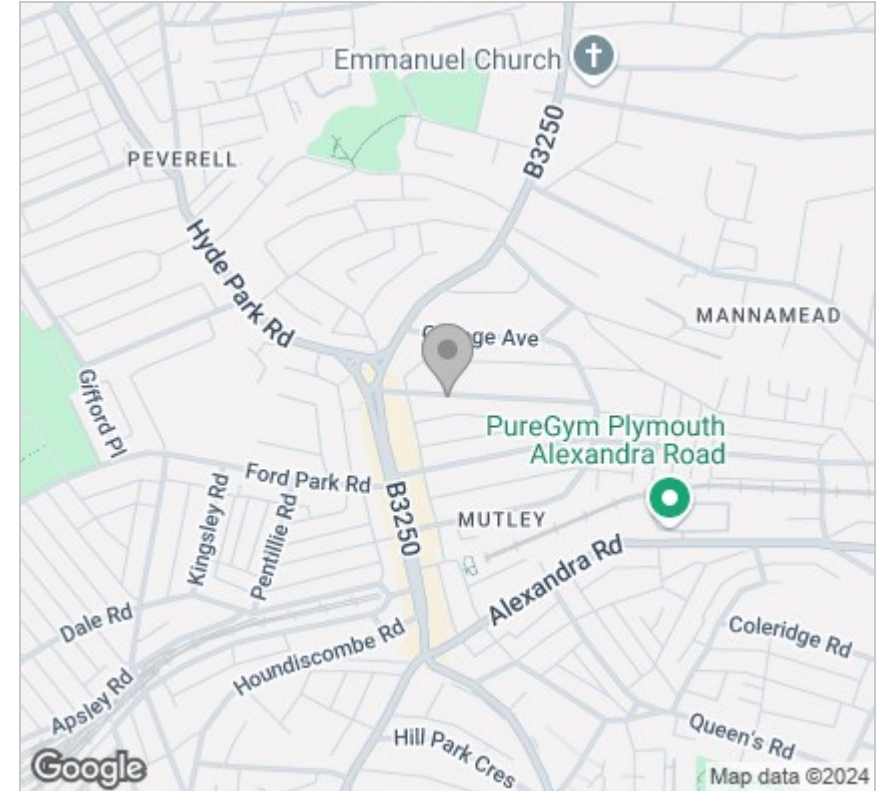

Energy Efficiency Graph

